



## Metric 4.1.1

### Adequate Infrastrucure and other Facilities

#### LIST OF SUPPORTING DOCUMENTS

Sr no	Document	Supporting Document
1	Building Plan	
2	Photo of Building	
3	Area Statement	
4	Photo of classroom with ICT Facilities	
5	Photo of Computer Lab	
6	Photo of Library Facilities	
7	Photos of Seminar Halls and Auditorium	
8	Photos of Cultural Facilities	
9	Photos of Sports and Yoga Facility	
10	Photos of Other Facilities	



Director  
Sai Balaji Education Society's  
Sai Balaji International Institute  
of Management Sciences  
Pune



SAIBALAJI EDUCATIONAL SOCIETY  
SAIBALAJI INTERNATIONAL INSTITUTE OF MANAGEMENT SCIENCES **SBIIMS**  
SBIIMS PUNE

Affiliated to Savitribai Phule Pune University  
Approved by AICTE, Ministry of HRD, Govt. of India

## Building Plan

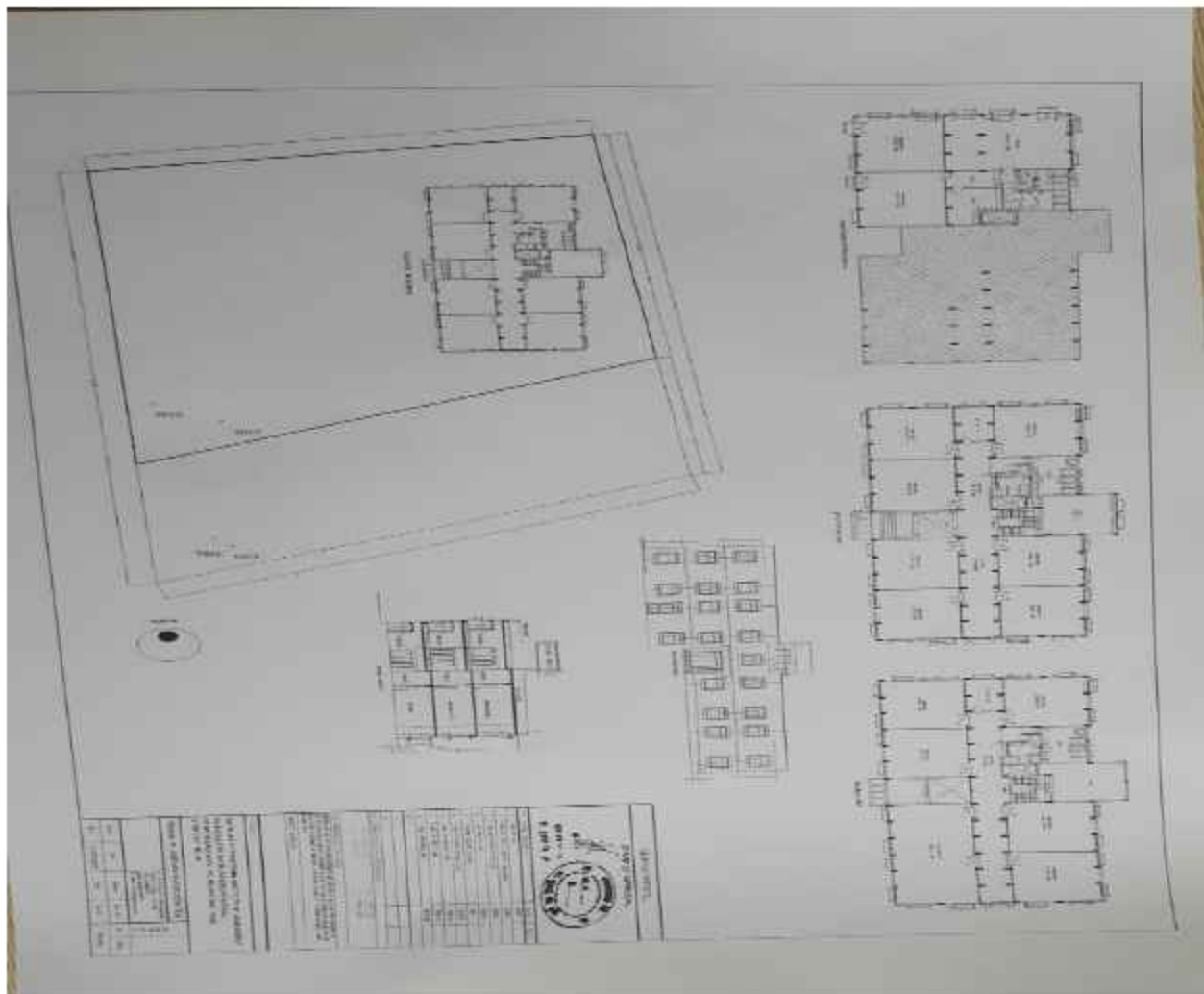



SAIBALAJI EDUCATIONAL SOCIETY  
SAIBALAJI INTERNATIONAL INSTITUTE OF MANAGEMENT SCIENCES **SBIIMS**  
SBIIMS PUNE

Affiliated to Savitribai Phule Pune University  
Approved by AICTE, Ministry of HRD, Govt. of India

## Photo of Building





Pimpri-Chinchwad, Maharashtra, India  
64, Hinjawadi - Kasarsai Rd, Hotala, Pimpri-Chinchwad, Nere, Maharashtra 411057, India  
Lat 18.61681°  
Long 73.705206°  
17/04/24 03:32 PM GMT +05:30

 **GPS Map Camera**



## Area Statement

Room No	Room type (mention Class Room/ Lab/ Toilet, etc.)	Carpet Area (in sq.mtr)	Completion of Flooring	Completion of Walls and painting	Completion of Electrification and lighting
DR -1	Director Room	35	Yes	Yes	Yes
MO-1	Main Office-1	66	Yes	Yes	Yes
MO-2	Main Office-2	66	Yes	Yes	Yes
MO-3	Main Office-3	66	Yes	Yes	Yes
A-1	Admin-1	66	Yes	Yes	Yes
A-2	Admin-2	25	Yes	Yes	Yes
A-3	Admin-3	25	Yes	Yes	Yes
A-4	Admin-4	25	Yes	Yes	Yes
A-5	Admin-5	30	Yes	Yes	Yes
T & P-1	Training & Placement Office	50	Yes	Yes	Yes
SH -1	Seminar Hall	150	Yes	Yes	Yes
CL -1	Computer Lab -1	150	Yes	Yes	Yes
L-1	Library	150	Yes	Yes	Yes
D O -1	Department Office	20	Yes	Yes	Yes
A-7	Maintenance	10	Yes	Yes	Yes
A-8	Security	10	Yes	Yes	Yes
A-9	House Keeping	10	Yes	Yes	Yes
A-10	Pantry	10	Yes	Yes	Yes
A-11	HOD Cabin	10	Yes	Yes	Yes
C-1	Cafeteria -1 (Shed)	150	Yes	Yes	Yes
BCR-1	Boys Common Room	66	Yes	Yes	Yes
GCR-1	Girls Common Room	66	Yes	Yes	Yes
CR-1	Class Room-1	66	Yes	Yes	Yes
CR-2	Class Room-2	66	Yes	Yes	Yes

CR-3	Class Room-3	66	Yes	Yes	Yes
CR-4	Class Room-4	66	Yes	Yes	Yes
CR-5	Class Room-5	66	Yes	Yes	Yes
CR-6	Class Room-6	66	Yes	Yes	Yes
CR-8	Class Room-6	66	Yes	Yes	Yes
CR-9	Class Room-6	66	Yes	Yes	Yes
TR-1	Tutorial Room-1	66	Yes	Yes	Yes
TR-2	Tutorial Room-2	66	Yes	Yes	Yes
SS-1	Stationary Store	10	Yes	Yes	Yes
T-1	Toilet-1	50	Yes	Yes	Yes
T-2	Toilet-2	50	Yes	Yes	Yes
T-3	Toilet -3	50	Yes	Yes	Yes



### Photo of classroom with ICT Facilities





**GPS Map Camera**  
Nerhe, Maharashtra, India  
JP84+GF3, Nerhe, Maharashtra 410506, India  
Lat 18.616715°  
Long 73.705434°  
10/04/23 10:44 AM GMT +05:30



**GPS Map Camera**  
Nerhe, Maharashtra, India  
JP84+GF3, Nerhe, Maharashtra 410506, India  
Lat 18.616715°  
Long 73.705434°  
10/04/23 10:43 AM GMT +05:30





SAIBALAJI EDUCATIONAL SOCIETY  
SAIBALAJI INTERNATIONAL INSTITUTE OF MANAGEMENT SCIENCES **SBIIMS**  
SBIIMS PUNE

Affiliated to Savitribai Phule Pune University  
Approved by AICTE, Ministry of HRD, Govt. of India

## Photo of Computer Lab





 **GPS Map Camera**



**Nerhe, Maharashtra, India**  
**JP83+WW6, Nerhe, Maharashtra 410506, India**  
**Lat 18.616793°**  
**Long 73.705376°**  
**10/04/23 10:10 AM GMT +05:30**

Google



### Photo of Library Facilities





GPS Map Camera



Nerhe, Maharashtra, India  
JP94+43P, Nerhe, Maharashtra 410506, India  
Lat 18.617248°  
Long 73.705538°  
10/04/23 10:28 AM GMT +05:30



GPS Map Camera



Nerhe, Maharashtra, India  
JP83+WW6, Nerhe, Maharashtra 410506, India  
Lat 18.616953°  
Long 73.705329°  
10/04/23 10:29 AM GMT +05:30



## Photos of Seminar Halls and Auditorium







SAIBALAJI EDUCATIONAL SOCIETY  
SAIBALAJI INTERNATIONAL INSTITUTE OF MANAGEMENT SCIENCES  
SBIIMS PUNE



Affiliated to Savitribai Phule Pune University  
Approved by AICTE, Ministry of HRD, Govt. of India

## Photos of Cultural Facilities









Nere, Maharashtra, India  
JP84+P8C, Nere, Maharashtra 410506, India  
Lat 18.616605°  
Long 73.708431°  
27/10/23 01:21 PM GMT +05:30

GPS Map Camera



Pune, Maharashtra, India  
JMPW+GMP, Maharashtra 410506, India  
Lat 18.636199°  
Long 73.696501°  
08/09/23 01:03 PM GMT +05:30

GPS Map Camera



SAIBALAJI EDUCATIONAL SOCIETY  
SAIBALAJI INTERNATIONAL INSTITUTE OF MANAGEMENT SCIENCES  
SBIIMS PUNE



Affiliated to Savitribai Phule Pune University  
Approved by AICTE, Ministry of HRD, Govt. of India

## Photos of Sports and Yoga Facility



**SAIBALAJI GROUP OF INSTITUTES**  
SBPS | SBIMMS | SBIMHRD(W) | RBMCACS | SBIC  
 IN ASSOCIATION WITH



**SAIBALAJI VISTA 2K22**  
**DUATHLON**  
**20 MARCH 2K22**  
THE ONLY OLYMPIC DISTANCE DUATHLON IN ANY COLLEGE FEST OF INDIA

**PRIZE**

• 1st • ₹21,000/-  
 • 2nd • ₹11,000/-  
 • 3rd • ₹5,000/-

**5 KM : RUNNING**  
**40 KM : CYCLING**  
**10 KM : RUNNING**

**REGISTRATION FEE**  
**₹299/- ONLY**

Contact No. 7878995168  
 7058234990  
 8386101881

• EACH PARTICIPANT GETS  
 BIKI CHOP FISHING, T-SHIRT,  
 CERTIFICATE





rotary Rotaract

**SAIBALAJI GROUP OF INSTITUTES**  
IIMS | SBIMMS | IIMHRD(W) | RBMCACS | SBPS | SBIC  
 IN ASSOCIATION WITH ROTARACT CLUB OF SBES

ORGANIZES

**CORPORATE FOOTBALL LEAGUE**

DATE: 1<sup>st</sup>, 12<sup>th</sup>, 13<sup>th</sup> Feb

Every Team 5000/-

**FUTZELO 2K22**

First Prize - ₹25,000  
 Runner Up - ₹10,000

Contact:-  
 Prof. Jyoti Khosla - 9800000000  
 Jyoti Khosla - 9800000000  
 Sakshi Kapse - 9800000000  
 Sakshi Kapse - 9800000000

Format: 100+ Football  
 Ground: 7-8-1000  
 2 Matches



Basketball and football





## Photos of Other Facilities

### Drinking Water



### Two wheeler Parking



## Car Parking



## Fire



# Solar



# Generator





# Water Filter



# Toilet



# Hostel Boys Sigma 1



GPS Map Camera



Google

Nere, Maharashtra, India  
JP93+GFX, Nere, Maharashtra 410506, India  
Lat 18.618819°  
Long 73.703957°  
14/05/24 04:16 PM GMT +05:30

## Medic Room



## Sport Ground



# Gym

